

## Index

<u>Pages 1 à 15 coffrets encastrés</u>	(LxHxP)	Compteur	TC
1. UP60802	600x800x230	1	1
2. UP60120TT2	600x1200x230	1	1
3. UP801003	800x1000x230	2	1
4. UP80140TT3	800x1400x230	2	1
5. UP8580TT2	850x800x230	1	1
6. UP100100TT3 / SIESA	1000x1000x230	2	1
7. UP10570TT2	1050x700x230	1	1
8. UP11080TT2 / ESR	1100x800x230	1	1
9. UP11080TT2 / SEIC	1100x800x230	1	1
10. UP11080TT3 / ESR	1100x800x230	2	1
11. UP11080TT3 / SEIC	1100x800x230	2	1
12. UP11080TT4 / ESR	1100x800x230	3	1
13. UP11080TT4 / SEIC	1100x800x230	3	1
14. UP13070TT3	1300x700x230	2	1
15. UP130100TT4 / SIESA	1300x1000x230	2	1

# Coffret Alu UP 600 x 800 x 230 mm

Niche 630 x 830 x 240 mm

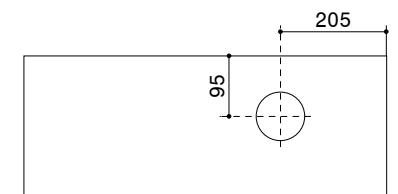
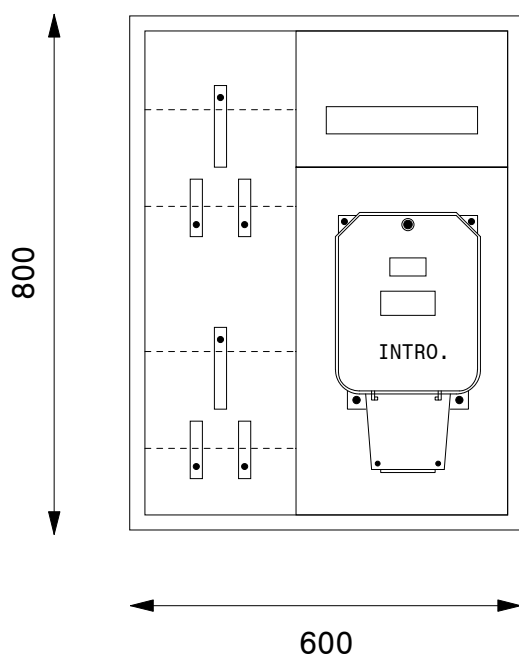
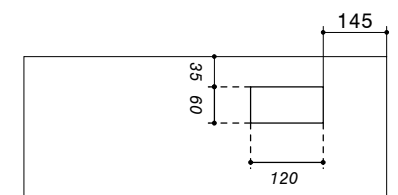

Type: UP60802

Equipement:

- 1 Emplacement introduction 63A
- 1 Emplacements compteurs
- 1 Emplacement TC
- 1 Emplacements appareils
- 1 Coupe-circuit TC 1PN 25A plb.
- 1 Borne de terre CU 16mm<sup>2</sup>

Serrures:

Porte: Kaba 5000

# Coffret Alu UP 600 x 1200 x 230 mm

Niche 630 x 1230 x 240 mm

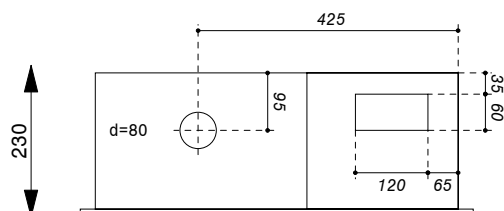
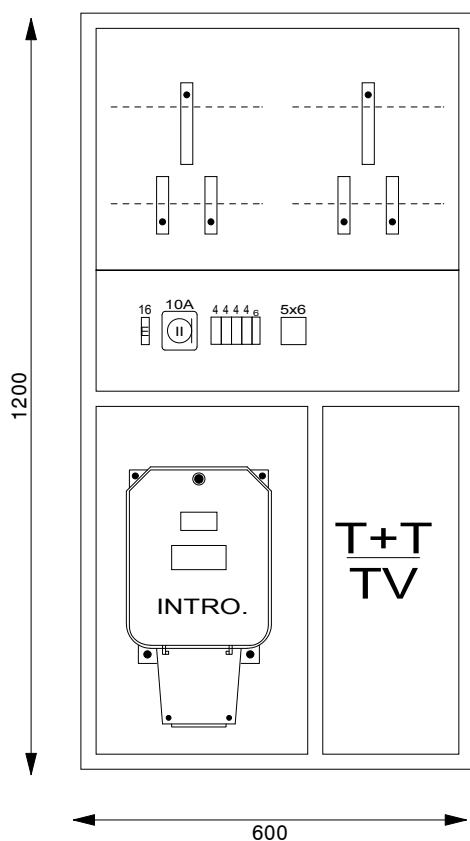
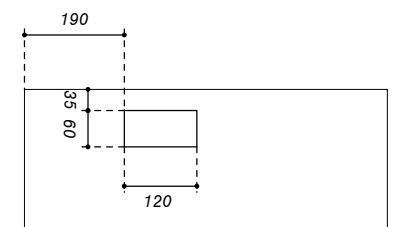

Type: UP60120TT2

Equipement:

- 1 Emplacement introduction 63A
- 2 Emplacements compteurs
- 1 Emplacement TC
- 1 Emplacement appareils
- 1 Coupe-circuit 1PN 25A plb.
- 1 Borne de terre CU 16mm<sup>2</sup>

Serrures:

- Porte: Kaba 5000
- Compartiment TT: Clé carré 6x6

# Coffret Alu UP 800 x 1000 x 230 mm

Niche 830 x 1030 x 240 mm

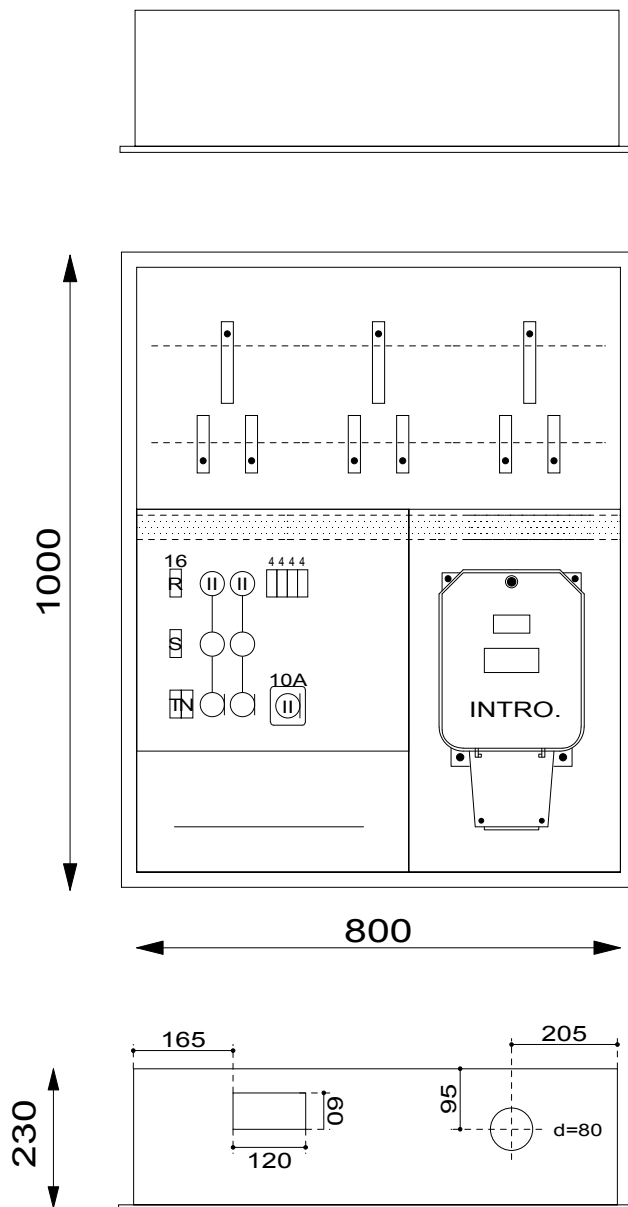

Type: UP1001003

Equipement:

- 1 Emplacement introduction 63A
- 2 Emplacements compteurs
- 1 Emplacement TC
- 3 Emplacements appareils
- 2 Coupe-circuit 3PN 25A
- 1 Coupe-circuit 1PN 25A plb.
- 3 ou 4 Disjoncteur 1P 4A TC
- 1 Borne de terre CU 16mm<sup>2</sup>

Serrures:

Porte: Kaba 5000

# Coffret Alu UP 800 x 1400 x 230 mm

Niche 830 x 1430 x 240

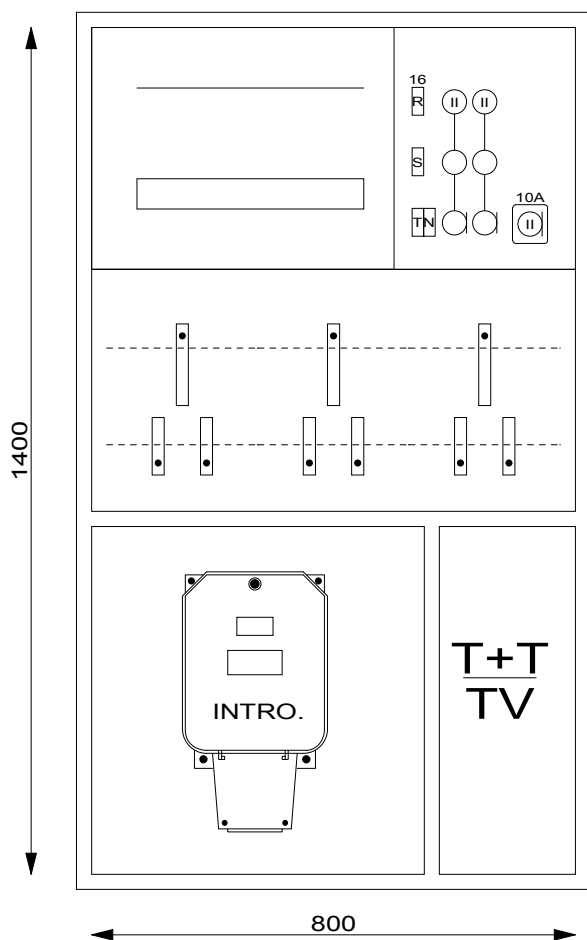
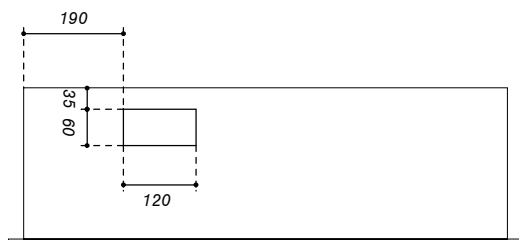

Type: UP80140TT3

Equipement:

- 1 Emplacement introduction 63A
- 2 Emplacements compteurs
- 1 Emplacement TC
- 2 Emplacements appareils
- 1 Emplacements bornes
- 2 Coupe-circuit 3PN 25A
- 1 Coupe-circuit TC 1PN 25A plb.
- 3 ou 4 Disjoncteurs 1P 4A TC
- 1 Borne de terre CU 16mm<sup>2</sup>

Serrures:

- Porte: Kaba 5000
- Compartiment TT: Clé carré 6x6

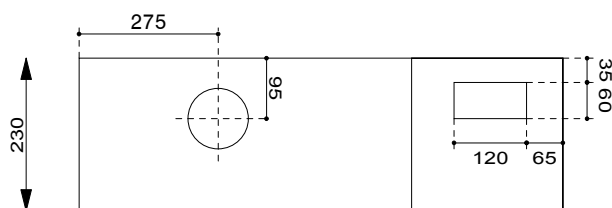

# Coffret Alu UP 850 x 800 x 230 mm

Niche 880 x 830 x 240 mm

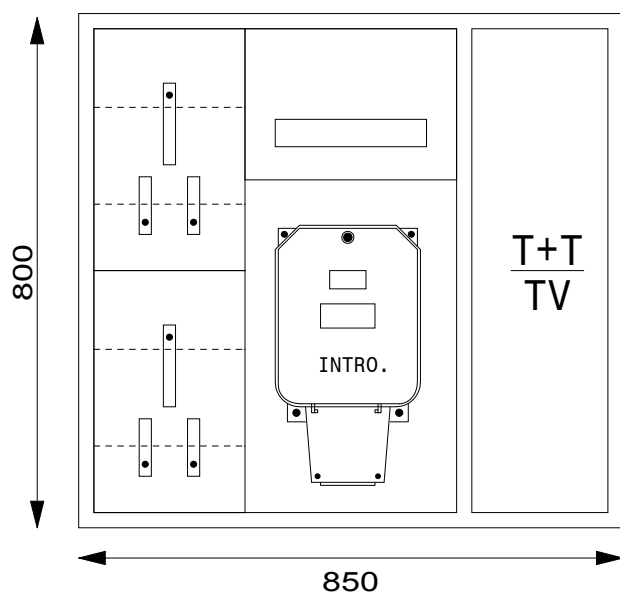
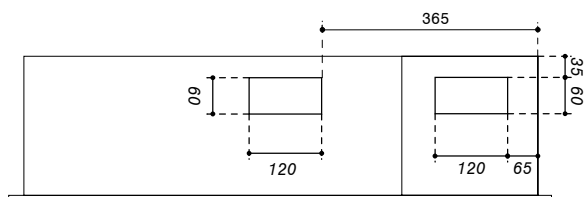

Type: UP8580TT2

Equipement:

- 1 Emplacement introduction 63A
- 1 Emplacement compteur
- 1 Emplacement TC
- 1 Emplacement appareils
- 1 Coupe-circuit TC 1PN 25A plb.
- 1 Borne de terre CU 16mm<sup>2</sup>

Serrures:

- Porte: Kaba 5000
- Compartiment TT: Clé carré 6x6

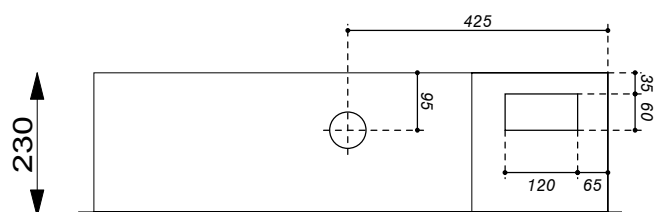

# Coffret Alu UP 1000 x 1000 x 230 mm

Niche 1030 x 1030 x 240 mm

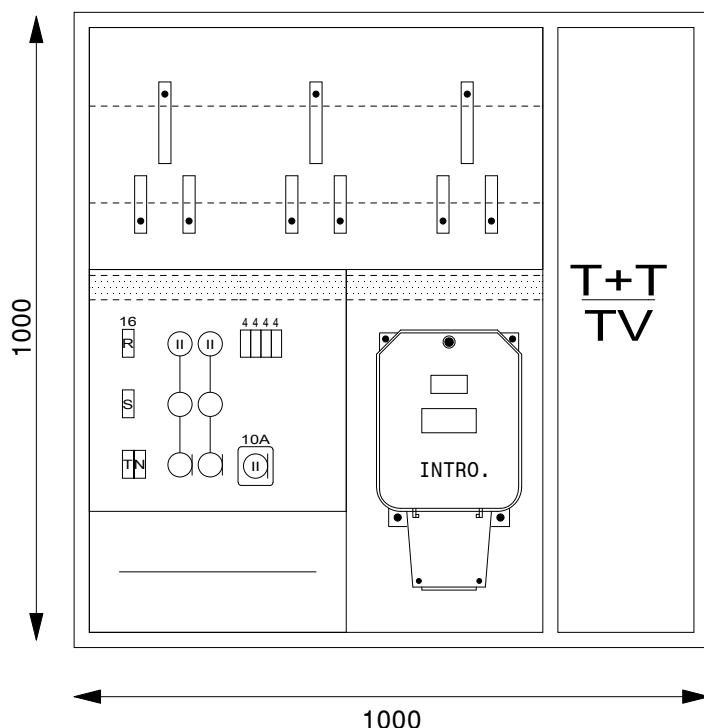

Type: UP100100TT3

#### Equipement:

- 1 Emplacement introduction 63A
- 2 Emplacements compteurs
- 1 Emplacement TC
- 3 Emplacements appareils
- 2 Coupe-circuit 3PN 25A
- 1 Coupe-circuit 1PN 25A plb.
- 3 ou 4 Disjoncteur 1P 4A TC
- 1 Borne de terre CU 16mm<sup>2</sup>

#### Serrures:

- Porte: Kaba 5000
- Compartiment TT: Clé carré 6x6

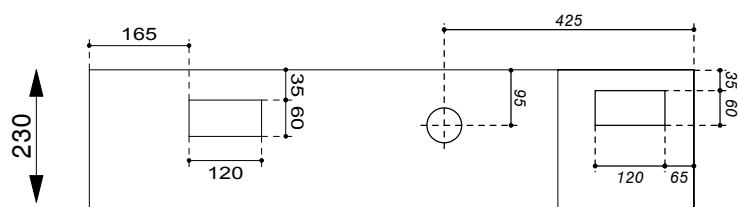

# Coffret Alu UP 1050 x 700 x 230 mm

Niche 1080 x 730 x 240 mm

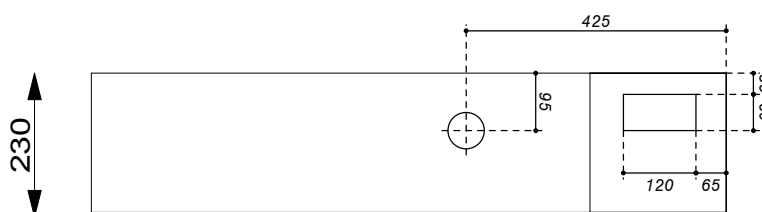
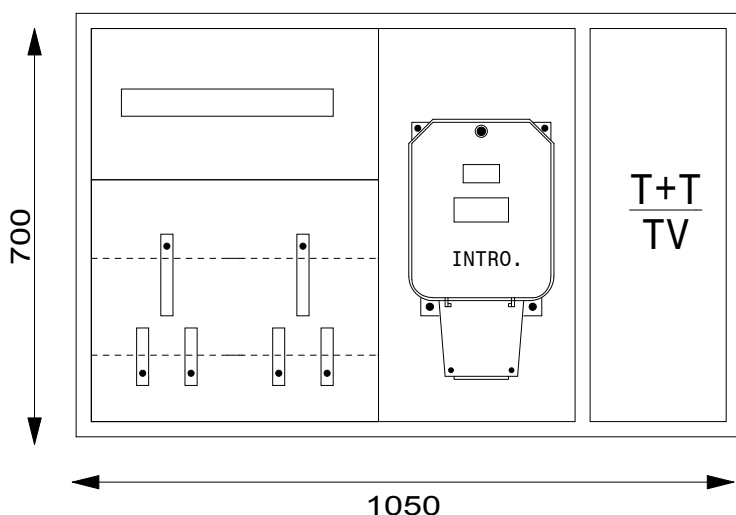

Type: UP10570TT2

Equipement:

- 1 Emplacement introduction 63A
- 1 Emplacement compteur
- 1 Emplacement TC
- 1 Emplacement appareils
- 1 Coupe-circuit 1PN 25A plb.
- 1 Borne de terre CU 16mm<sup>2</sup>

Serrures:

- Porte: Kaba 5000
- Compartiment TT: Clé carré 6x6



# Coffret Alu UP 1100 x 800 x 230 mm

Niche 1130 x 830 x 240 mm

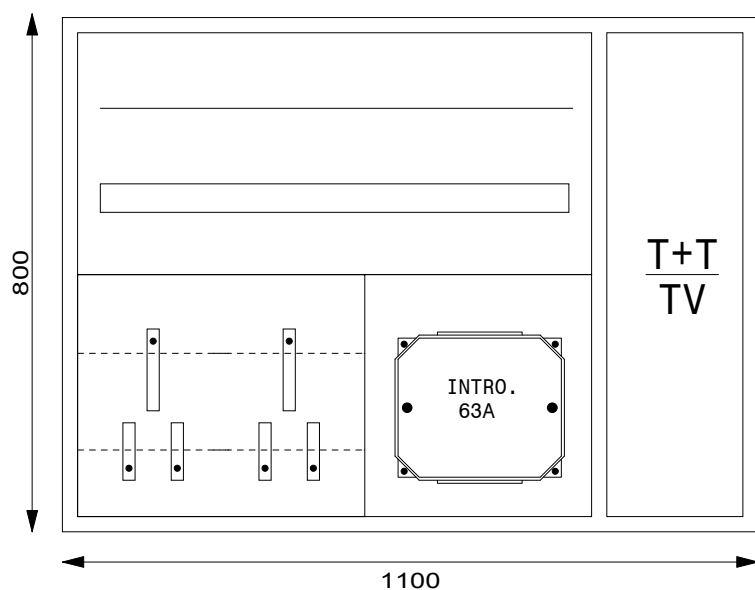
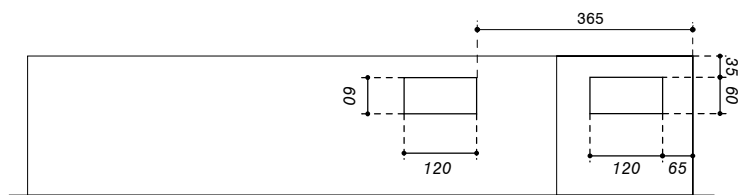

Type: UP11080TT2

Equipement:

- 1 Emplacement introduction 63A
- 1 Emplacement compteur
- 1 Emplacement TC
- 1 Emplacement appareils
- 1 Emplacement bornes
- 1 Coupe-circuit 1PN 25A plb.
- 1 Borne de terre CU 16mm<sup>2</sup>

Serrures:

- Porte: Kaba 5000
- Compartiment TT: Clé carré 6x6

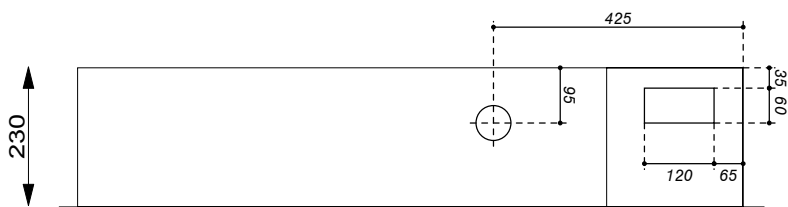

# Coffret Alu UP 1100 x 800 x 230 mm

Niche 1130 x 830 x 240 mm

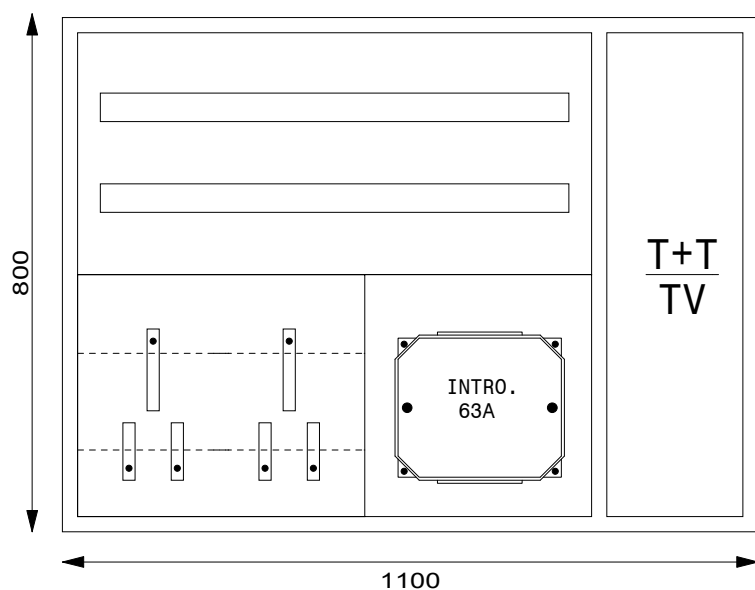
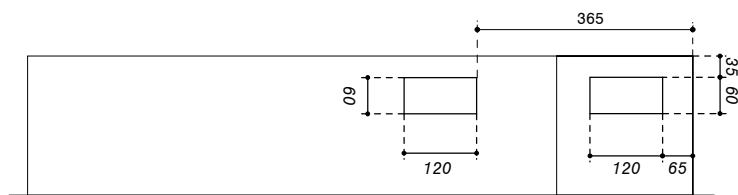

Type: UP11080TT2

Equipement:

- 1 Emplacement introduction 63A
- 1 Emplacement compteur
- 1 Emplacement TC
- 2 Emplacement appareils
- 1 Coupe-circuit 1PN 25A plb.
- 1 Borne de terre CU 16mm<sup>2</sup>

Serrures:

- Porte: Kaba 5000
- Compartiment TT: Clé carré 6x6

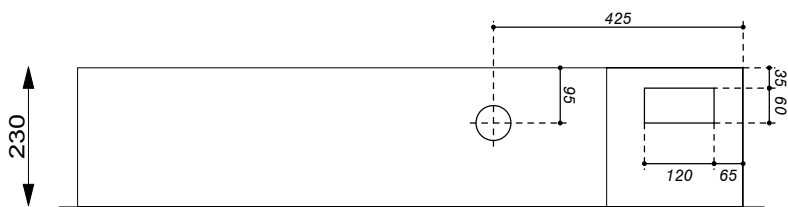

# Coffret Alu UP 1100 x 800 x 230 mm

Niche 1130 x 830 x 240 mm

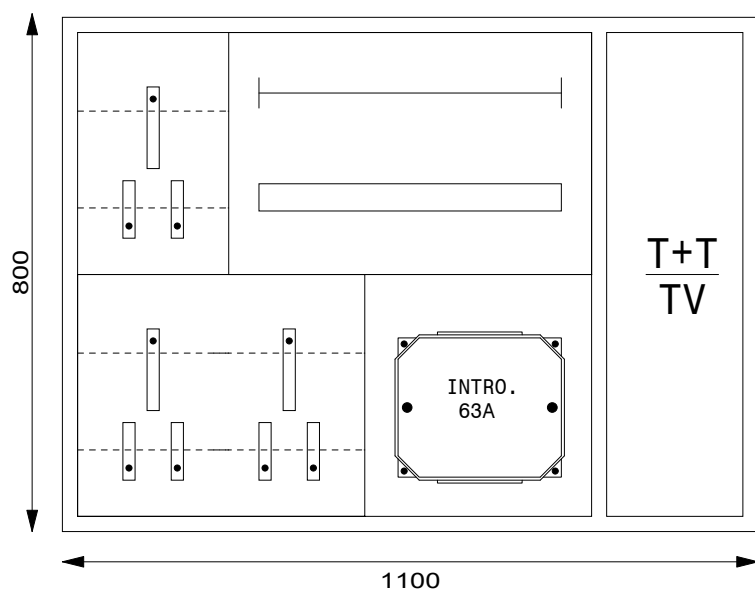
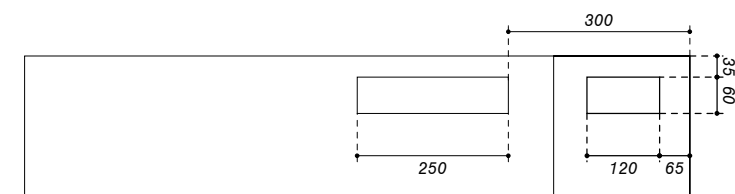

Type: UP11080TT3

Equipement:

- 1 Emplacement introduction 63A
- 2 Emplacements compteurs
- 1 Emplacement TC
- 1 Emplacement appareils
- 1 Emplacement bornes
- 1 Coupe-circuit TC 1PN 25A plb.
- 1 Borne de terre CU 16mm<sup>2</sup>

Serrures:

- Porte: Kaba 5000
- Compartment TT: Clé carré 6x6

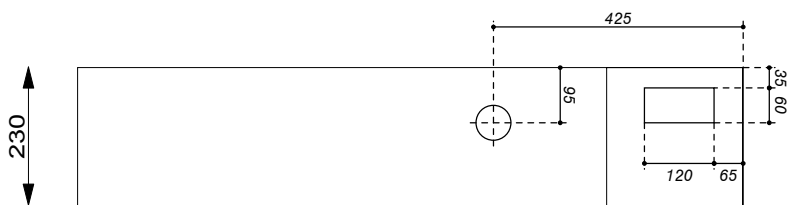

# Coffret Alu UP 1100 x 800 x 230 mm

Niche 1130 x 830 x 240 mm

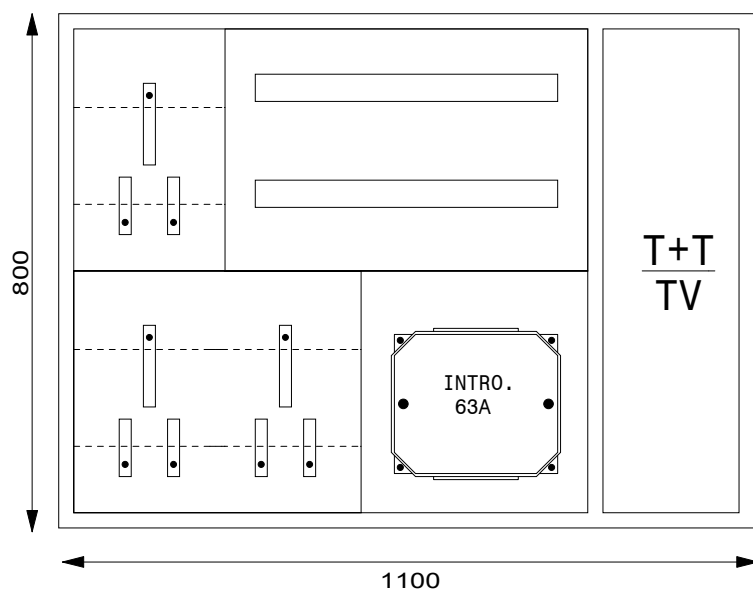
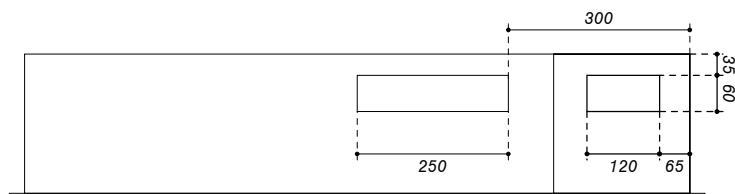

Type: UP11080TT3

Equipement:

- 1 Emplacement introduction 63A
- 2 Emplacements compteurs
- 1 Emplacement TC
- 2 Emplacements appareils
- 1 Coupe-circuit TC 1PN 25A plb.
- 1 Borne de terre CU 16mm<sup>2</sup>

Serrures:

- Porte: Kaba 5000
- Compartiment TT: Clé carré 6x6

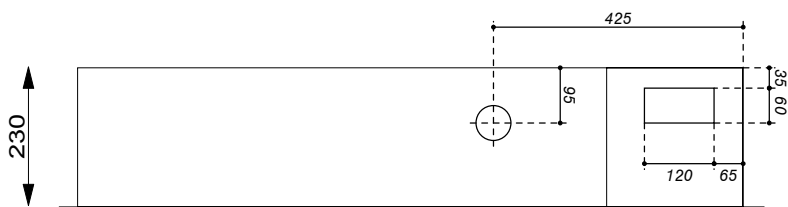

# Coffret Alu UP 1100 x 800 x 230 mm

Niche 1130 x 830 x 240 mm

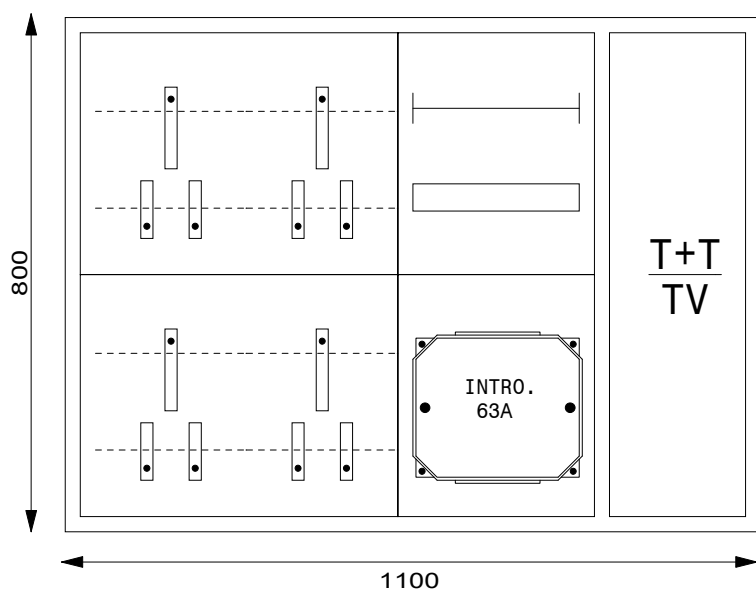
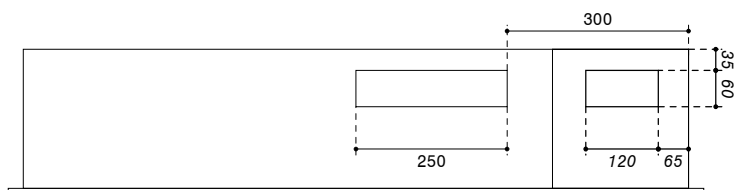

Type: UP11080TT4

Equipement:

- 1 Emplacement introduction 63A
- 3 Emplacements compteurs
- 1 Emplacement TC
- 1 Emplacement appareils
- 1 Emplacement bornes
- 1 Coupe-circuit 1PN 25A plb.
- 1 Borne de terre CU 16mm<sup>2</sup>

Serrures:

- Porte: Kaba 5000
- Compartiment TT: Clé carré 6x6

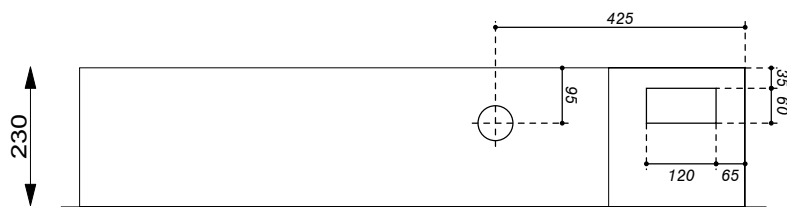

# Coffret Alu UP 1100 x 800 x 230 mm

Niche 1130 x 830 x 240 mm

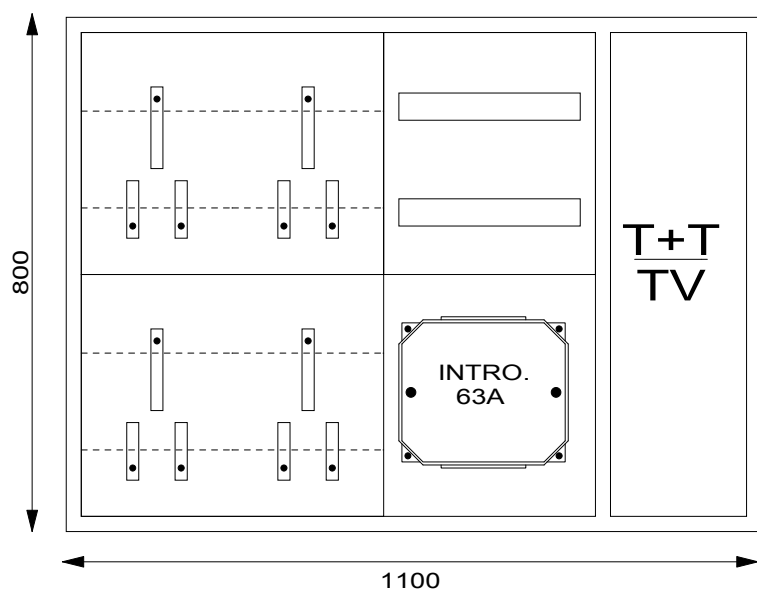
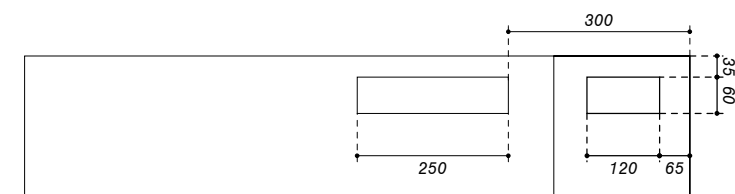

Type: UP11080TT4

Equipement:

- 1 Emplacement introduction 63A
- 3 Emplacements compteurs
- 1 Emplacement TC
- 2 Emplacements appareils
- 1 Coupe-circuit 1PN 25A plb.
- 1 Borne de terre CU 16mm<sup>2</sup>

Serrures:

- Porte: Kaba 5000
- Compartiment TT: Clé carré 6x6

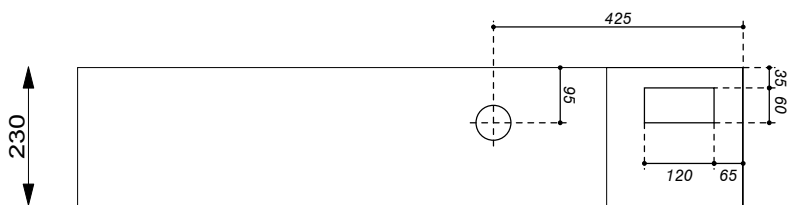

# Coffret Alu UP 1100 x 800 x 230 mm

Niche 1130 x 830 x 240 mm

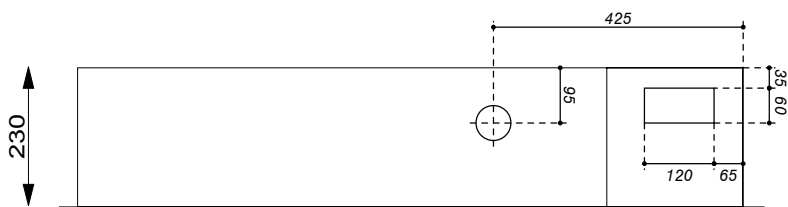
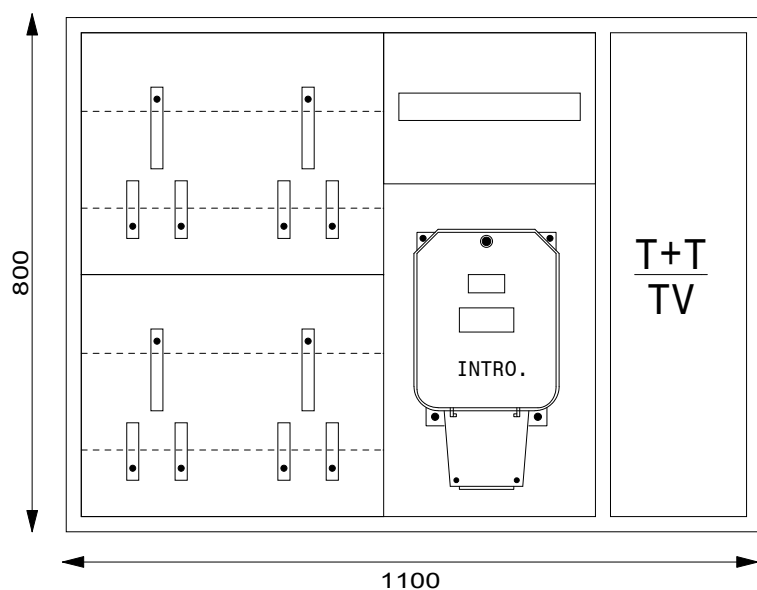
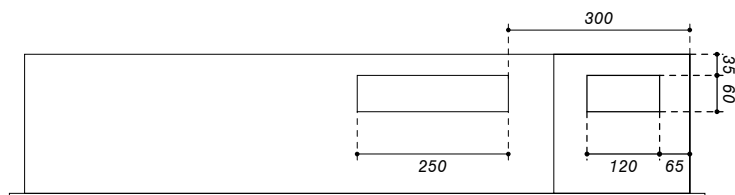

Type: UP11080TT4

Equipement:

- 1 Emplacement introduction 63A
- 3 Emplacements compteurs
- 1 Emplacement TC
- 1 Emplacement appareils
- 1 Coupe-circuit 1PN 25A plb.
- 1 Borne de terre CU 16mm<sup>2</sup>

Serrures:

- Porte: Kaba 5000
- Compartiment TT: Clé carré 6x6

# Coffret Alu UP 1300 x 700 x 230 mm

Niche 1330 x 730 x 240 mm

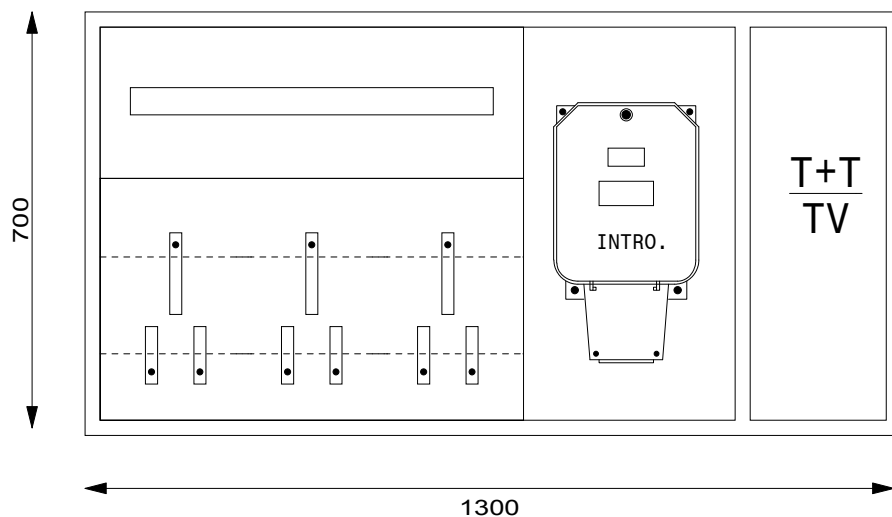

Type: UP13070TT3

Equipement:

- 1 Emplacement introduction 63A
- 2 Emplacements compteurs
- 1 Emplacement TC
- 1 Emplacement appareils
- 1 Coupe-circuit TC 1PN 25A plb.
- 1 Borne de terre CU 16mm<sup>2</sup>

Serrures:

Porte: Kaba 5000

Compartment TT: Clé carré 6x6

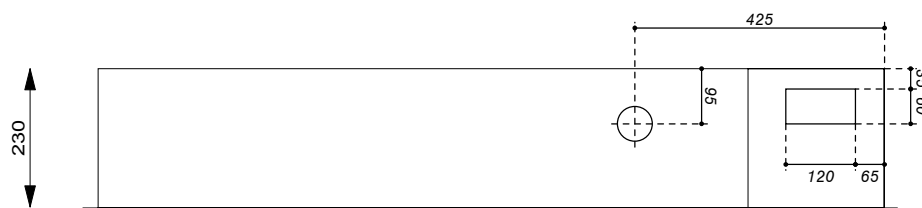



# Coffret Alu UP 1300 x 1000 x 230 mm

Niche 1330 x 1030 x 240 mm

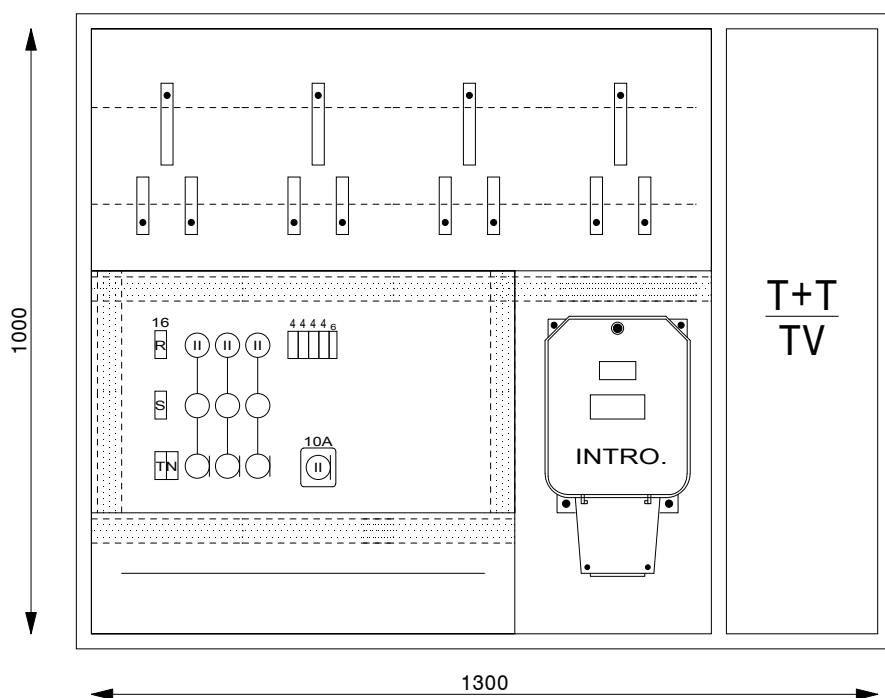

Type: UP130100TT4

**Equipement:**

- 1 Emplacement introduction 63A
- 3 Emplacements compteurs
- 1 Emplacement TC
- 3 Emplacements appareils
- 1 Emplacement bornes
- 3 Coupe-circuit 3PN 25A
- 1 Coupe-circuit TC 1PN 25A plb.
- 3 ou 4 Disjoncteurs 1P 4A TC
- 1 Borne de terre CU 16mm<sup>2</sup>

**Serrures:**

- Porte: Kaba 5000
- Compartment TT: Clé carré 6x6

